

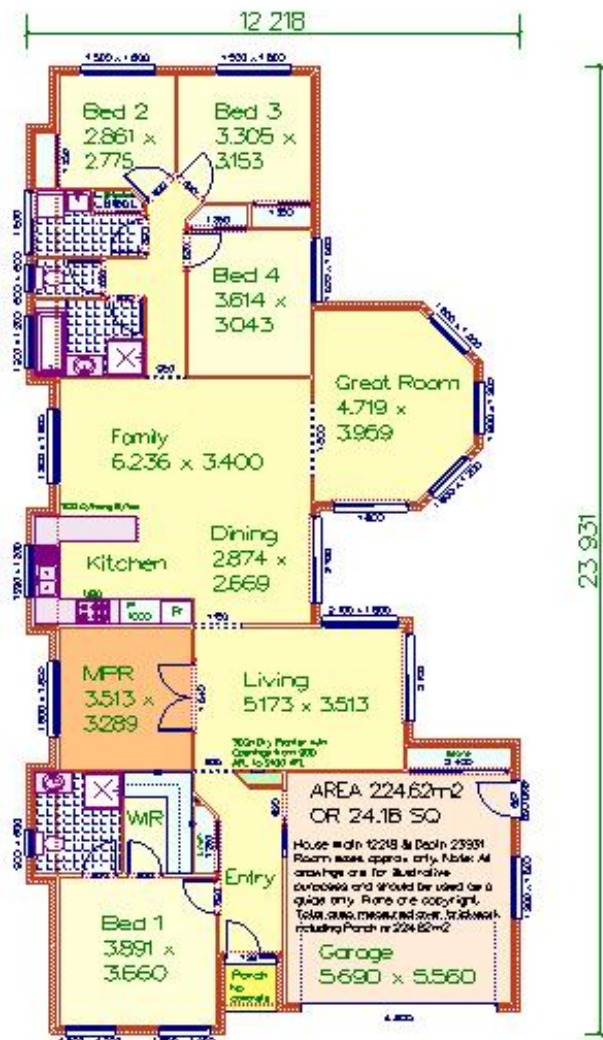

Artist Impression Front



THE BALMORAL EXECUTIVE 225

Area 224.62m² or 24.18 Squares

Overall depth 23.931m x overall width 12.218m

(Area measured over external walls including garage and external areas)

4 Bedrooms ~ Great Room ~ Multi Purpose Room (MPR) ~ Dining Room ~ Living Room ~ Family Room ~ Ensuite ~ Walk in Robe ~ Linen Cupboard ~ Broom Cupboard ~ Built in Robes ~ Double Lock Up Garage with Store Cupboard ~ Pantry ~ Internal Dry Planter to Entry with Plaster Feature Openings ~ Formal Entry ~ Front Porch

This design is the exclusive property of

Pacific Designer Homes Pty Ltd

The Best Move You'll Ever Make!

ACN 055 718 048

In accordance with our continuing product development we reserve the right to alter designs, specifications and price without prior notice. Brochures are indicative and to be used as a guide only showing suggested landscaping, etc. Room sizes are approximate only. Refer to inclusions list and price list. Plans are strictly the copyright of Pacific Designer Homes Pty Ltd